

END ELEVATION NORMAL TO SKEW

## LOOKING DOWNSTREAM

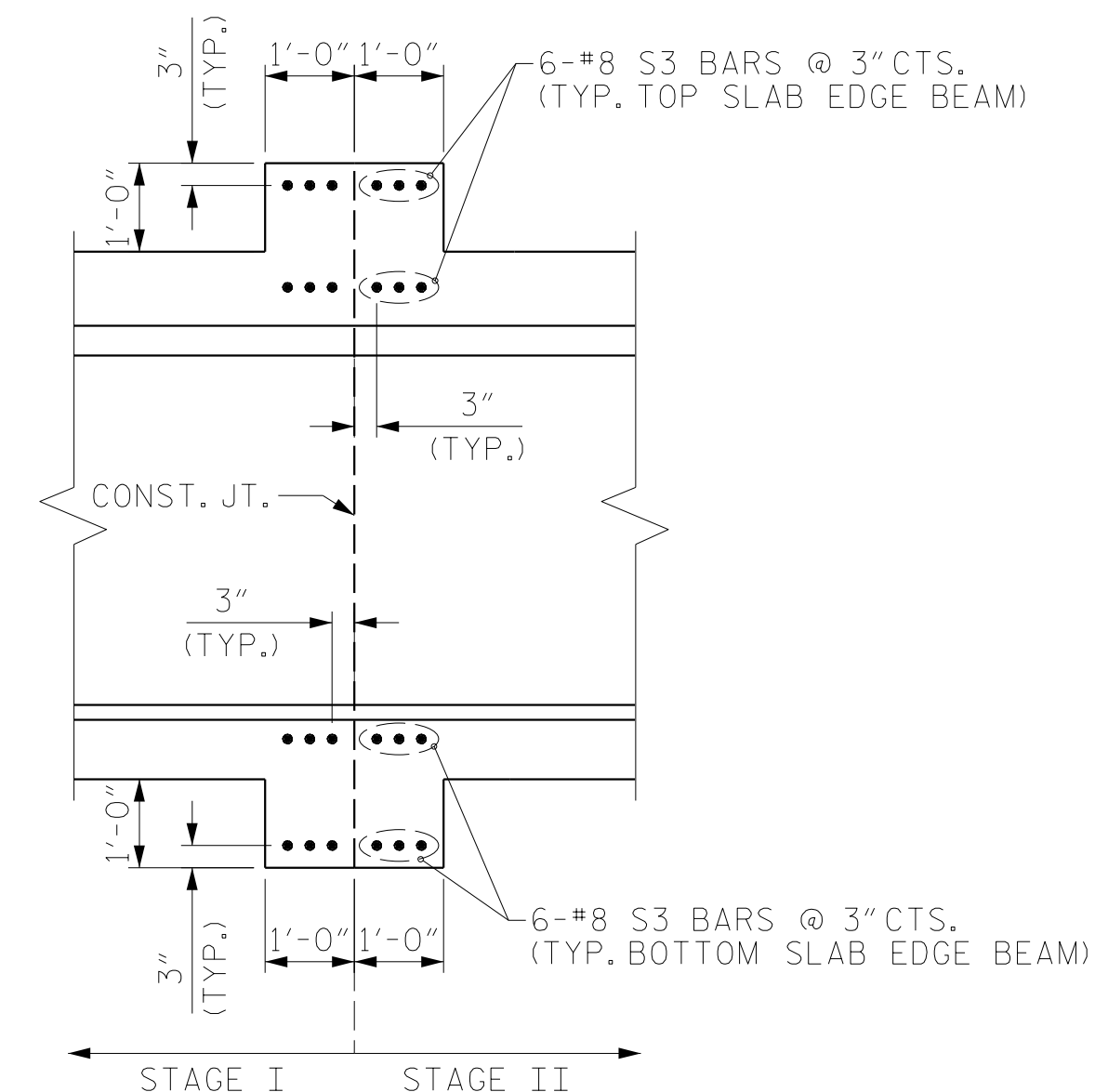

## CULVERT SPLICE DETAILS

PROJECT NO. BP14.R002  
HAYWOOD COUNTY  
 STATION: 12+82.90 -L188-

SHEET 4 OF 8

DOCUMENT NOT CONSIDERED  
FINAL UNLESS ALL  
SIGNATURES COMPLETED

